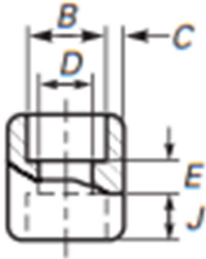

Aceros – Válvulas – Tuberías y Accesorios – Sistemas Contra Incendio

CLASS 3000
COUPLING SOCKET-WELD

 Conforme a:
 ASME B16.11 y ASTM A-105

COUPLING CLASS 3000 SOCKET WELD														
Diámetro Nominal		Rating pressure	Diámetro Interno Socked		Diámetro Interno Fitting		Espesor pared Socked		altura de Socked (min)		Longitud tramo diametro interno		Peso nominal	
			(B) [Nota 1]		(D) [Nota 1]		(C)		(J)		(E)		Aprox	
(NPS)	DN	Class	mm	inch	mm	inch	mm	inch	mm	inch	mm	inch	Lb	Kg
1/2"	15	3000	22.2	0.87	16.6	0.65	4.67	0.18	9.5	0.37	9.5	0.37	0.25	0.11
			21.8	0.86	15.0	0.59								
3/4"	20	3000	27.6	1.09	21.7	0.9	4.90	0.19	12.5	0.49	9.5	0.37	0.39	0.18
			27.2	1.07	20.2	0.8								
1"	25	3000	34.3	1.35	27.4	1.08	5.69	0.22	12.5	0.49	12.5	0.49	0.58	0.26
			33.9	1.33	25.9	1.02								
1-1/4"	32	3000	43.1	1.70	35.8	1.4	6.07	0.24	12.5	0.49	12.5	0.49	0.90	0.41
			42.7	1.68	34.3	1.4								
1-1/2"	40	3000	49.2	1.94	41.6	1.64	6.35	0.25	12.5	0.49	12.5	0.49	1.01	0.46
			48.8	1.92	40.1	1.58								
2"	50	3000	61.7	2.43	53.3	2.1	6.93	0.27	16.0	0.63	19.0	0.75	1.74	0.79
			61.2	2.41	51.7	2.0								
2-1/2"	65	3000	74.4	2.93	64.2	2.53	8.76	0.34	16.0	0.63	19.0	0.75	2.51	1.14
			73.9	2.91	61.2	2.41								
3"	80	3000	90.3	3.56	79.4	3.1	9.52	0.37	16.0	0.63	19.0	0.75	3.34	1.51
			89.8	3.54	76.4	3.0								
4"	100	3000	115.7	4.56	103.8	4.09	10.69	0.42	19.0	0.75	19.0	0.75	5.55	2.52
			115.2	4.54	100.7	3.96								

Nota:

1) Valores mínimos y máximos de las dimensiones indicadas