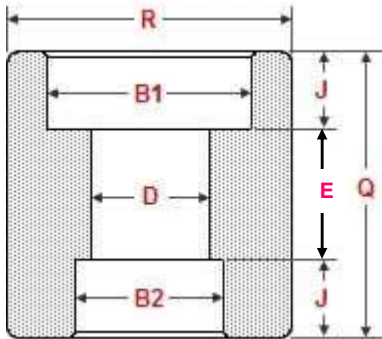

Aceros – Válvulas – Tuberías y Accesorios – Sistemas Contra Incendio

CLASS 3000
COUPLING REDUCTOR SOCKET-WELD

 Conforme a:
 ASME B16.11 y ASTM A-105

COUPLING REDUCTOR CLASS 3000 SOCKET WELDING

Diámetro Nominal		Rating pressure	Socket diámetro mayor		Socket diámetro menor		Diámetro Interno Fitting		Espesor pared Socket		altura de Socket (min)		Longitud tramo diámetro interno		Peso nominal	
			(B1) [Nota 1]	(B2) [Nota 1]	(D)	(C)	(J)	(E)	Aprox							
(NPS)	DN	Class	mm	inch	mm	inch	mm	inch	mm	inch	mm	inch	mm	inch	Lb	Kg
3/4 X 1/2	20 X 15	3000	27.6	1.09	22.2	0.87	16.6	0.7	4.90	0.19	12.5	0.49	9.5	0.37	0.42	0.19
			27.2	1.07	21.8	0.86	15.0	0.6								
1 X 3/4	25 X 20	3000	34.3	1.35	27.6	1.09	21.7	0.85	5.69	0.22	12.5	0.49	12.5	0.49	0.55	0.25
			33.9	1.33	27.2	1.07	20.2	0.80								
1 X 1/2	25 X 15	3000	34.3	1.35	22.2	0.87	16.6	0.7	5.69	0.22	12.5	0.49	12.5	0.49	0.60	0.27
			33.9	1.33	21.8	0.86	15.0	0.6								
1-1/4 X 1	32 X 25	3000	43.1	1.70	34.3	1.35	27.4	1.08	6.07	0.24	12.5	0.49	12.5	0.49	0.90	0.41
			42.7	1.68	33.9	1.33	25.9	1.02								
1-1/4 X 3/4	32 X 20	3000	43.1	1.70	27.6	1.09	21.7	0.9	6.07	0.24	12.5	0.49	12.5	0.49	1.08	0.49
			42.7	1.68	27.2	1.07	20.2	0.8								
1-1/2 X 1	40 X 25	3000	49.2	1.94	34.3	1.35	27.4	1.08	6.35	0.25	12.5	0.49	12.5	0.49	1.15	0.52
			48.8	1.92	33.9	1.33	25.9	1.02								
1-1/2 X 3/4	40 X 20	3000	49.2	1.94	27.6	1.09	21.7	0.9	6.35	0.25	12.5	0.49	12.5	0.49	1.30	0.59
			48.8	1.92	27.2	1.07	20.2	0.8								
2 X 1-1/4	50 X 40	3000	61.7	2.43	43.1	1.70	35.8	1.41	6.93	0.27	16.0	0.63	19.0	0.75	2.05	0.93
			61.2	2.41	42.7	1.68	34.3	1.35								
2 X 1	50 X 25	3000	61.7	2.43	34.3	1.35	27.4	1.1	6.93	0.27	16.0	0.63	19.0	0.75	2.14	0.97
			61.2	2.41	33.9	1.33	25.9	1.0								

COUPLING REDUCTOR CLASS 3000 SOCKET WELDING

Diámetro Nominal		Rating pressure	Socket diametro mayor		Socket diametro menor		Diámetro Interno Fitting		Espesor pared Socket		altura de Socket (min)		Longitud tramo diametro interno		Peso nominal	
(NPS)	DN		Class	(B1) [Nota 1]		(B2) [Nota 1]		(D)		(C)		(J)		(E)		Aprox
				mm	inch	mm	inch	mm	inch	mm	inch	mm	inch	mm	inch	Lb
2-1/2 X 2	65 X 50	3000	74.4	2.93	61.7	2.43	53.3	2.10	8.76	0.34	16.0	0.63	19.0	0.75	3.13	1.42
			73.9	2.91	61.2	2.41	51.7	2.04								
3 X 2	80 X 50	3000	90.3	3.56	61.7	2.43	53.3	2.1	9.52	0.37	16.0	0.63	19.0	0.75	4.14	1.88
			89.8	3.54	61.2	2.41	51.7	2.0								
4 X 3	100 X 80	3000	115.7	4.56	90.3	3.56	79.4	3.13	10.69	0.42	19.0	0.75	19.0	0.75	7.30	3.31
			115.2	4.54	89.8	3.54	76.4	3.01								

Nota:
 Valores mínimos y máximos de las dimensiones indicadas

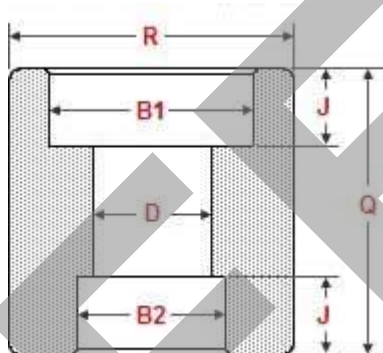

Conforme a:
 ASME B16.11 y ASTM A-105