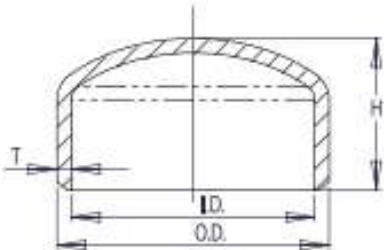

TAPON HEMBRA (CAPS)

WP-316/316L SCH 10

 Conforme a:
 ASME B16.9 y ASTM A-403

CAPS												
Diámetro Nominal		Identificación	Diámetro Externo (OD)		Diámetro Interno (ID)		espesor de pared (T)		ALTURA (H)		Peso nominal	
(NPS)	DN		Schedule N°	mm	inch	mm	inch	mm	inch	mm	inch	Lb
1/2"	15	10	21.3	0.84	17.12	0.67	2.1	0.083	25.4	1.00	0.02	0.04
1"	25	10	33.4	1.32	27.9	1.10	2.8	0.109	38.1	1.50	0.05	0.10
2"	50	10	60.3	2.38	54.79	2.16	2.8	0.109	38.1	1.50	0.10	0.23
2-1/2"	65	10	73.0	2.88	66.9	2.64	3.0	0.120	38.1	1.50	0.12	0.27
3"	80	10	88.9	3.50	82.80	3.26	3.0	0.120	50.8	2.00	0.19	0.42