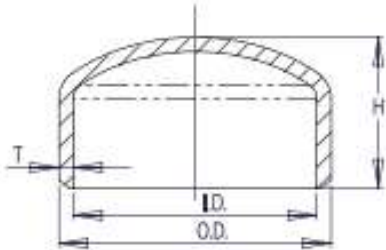

**TAPON HEMBRA (CAPS)**  
**SCH 40 y STD**

Conforme a:  
 ASME B16.9 - ASTM A-234

CAPS													
Diámetro Nominal		Identificación		Diámetro Externo (OD)		Diámetro Interno (ID)		espesor de pared (T)		ALTURA (H)		Peso nominal	
(NPS)	DN	Weight Class	Sch N°	mm	inch	mm	inch	mm	inch	mm	inch	Lb	Kg
1/2"	15	STD	40	21.3	0.84	15.80	0.62	2.8	0.109	25.4	1.00	0.08	0.04
3/4"	20	STD	40	26.7	1.05	20.9	0.82	2.9	0.113	25.4	1.00	0.14	0.06
1"	25	STD	40	33.4	1.32	26.6	1.05	3.4	0.133	38.1	1.50	0.21	0.10
1-1/4"	32	STD	40	42.2	1.66	35.1	1.38	3.6	0.140	38.1	1.50	0.33	0.15
1-1/2"	40	STD	40	48.3	1.90	40.9	1.61	3.7	0.145	38.1	1.50	0.54	0.24
2"	50	STD	40	60.3	2.38	52.5	2.07	3.9	0.154	38.1	1.50	0.80	0.36
2-1/2"	65	STD	40	73.0	2.88	62.7	2.47	5.2	0.203	38.1	1.50	1.00	0.45
3"	80	STD	40	88.9	3.5	77.9	3.1	5.5	0.216	50.8	2.0	1.70	0.77
4"	100	STD	40	114.3	4.5	102.3	4.0	6.0	0.237	63.5	2.5	2.80	1.27
5"	125	STD	40	141.3	5.6	128.2	5.0	6.6	0.258	76.2	3.0	4.6	2.1
6"	150	STD	40	168.3	6.6	154.1	6.1	7.1	0.280	88.9	3.5	6.9	3.1
8"	200	STD	40	219.1	8.6	202.7	8.0	8.2	0.322	101.6	4.0	11.8	5.4
10"	250	STD	40	273.1	10.8	254.5	10.0	9.3	0.365	127.0	5.0	20.8	9.4
12"	300	STD	-	323.9	12.8	304.8	12.0	9.5	0.375	152.4	6.0	30.3	13.7
14"	350	STD	30	355.6	14.0	336.6	13.3	9.5	0.375	165.1	6.5	36.5	16.6
16"	400	STD	30	406.4	16.0	387.4	15.3	9.5	0.375	177.8	7.0	43.5	19.7
18"	450	STD	-	457.2	18.0	438.2	17.3	9.5	0.375	203.2	8.0	57.0	25.9
20"	500	STD	20	508.0	20.0	489.0	19.3	9.53	0.375	228.6	9.0	75.7	34.3