

Aceros – Válvulas – Tuberías y Accesorios – Sistemas Contra Incendio

**CAPS
SCH 80 y XS**

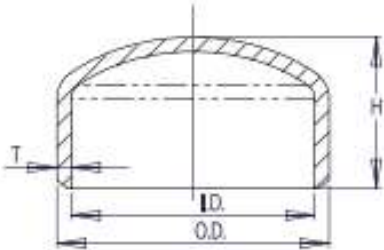

Conforme a:
ASME B16.9 - ASTM A-234

CAPS													
Diámetro Nominal		Identificación		Diámetro Externo (OD)		Diámetro Interno (ID)		espesor de pared (T)		ALTURA (H)		Peso nominal	
(NPS)	DN	Weight Class	Sch N°	mm	inch	mm	inch	mm	inch	mm	inch	Lb	Kg
1/2"	15	XS	80	21.3	0.840	13.9	0.546	3.7	0.147	25.4	1.000	0.10	0.05
3/4"	20	XS	80	26.7	1.050	18.8	0.742	5.6	0.219	25.4	1.000	0.16	0.07
1"	25	XS	80	33.4	1.315	24.3	0.957	4.5	0.179	38.1	1.500	0.28	0.13
1-1/4"	32	XS	80	42.2	1.660	32.5	1.278	4.9	0.191	38.1	1.500	0.48	0.22
1-1/2"	40	XS	80	48.3	1.900	38.1	1.500	5.1	0.200	38.1	1.500	0.67	0.30
2"	50	XS	80	60.3	2.375	49.3	1.939	5.5	0.218	38.1	1.500	0.92	0.42
2-1/2"	65	XS	80	73.0	2.875	59.0	2.323	7.0	0.276	38.1	1.500	1.30	0.59
3"	80	XS	80	88.9	3.500	73.7	2.900	7.6	0.300	50.8	2.000	2.10	0.95
4"	100	XS	80	114.3	4.500	97.2	3.826	8.6	0.337	63.5	2.500	3.50	1.59
5"	125	XS	80	141.3	5.563	122.3	4.813	9.5	0.375	76.2	3.000	5.80	2.63
6"	150	XS	80	168.3	6.625	146.3	5.761	11.0	0.432	88.9	3.500	9.30	4.22
8"	200	XS	80	219.1	8.625	193.7	7.625	12.7	0.500	101.6	4.000	16.00	7.26
12	300	XS	-	323.9	12.750	298.5	11.750	12.7	0.500	152.4	6.000	38.00	17.24
14	350	XS	-	355.6	14.000	330.2	13.000	12.7	0.500	165.1	6.500	47.00	21.32
16	400	XS	40	406.4	16.000	381.0	15.000	12.7	0.500	177.8	7.000	57.00	25.85
18"	450	XS	-	457.2	18.000	431.8	17.000	12.7	0.500	203.2	8.000	78.00	35.38
20"	500	XS	40	508.0	20.000	482.6	19.000	12.7	0.500	228.6	9.000	100.00	45.36