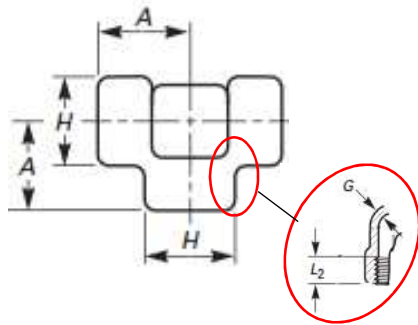

Aceros – Válvulas – Tuberías y Accesorios – Sistemas Contra Incendio

CLASS 3000
TEE RECTA C/ROSCA

Conforme a:
 ASME B16.11 y ASTM A-105

TEE CLASS 3000 CON ROSCA												
Diámetro Nominal		Rating pressure	Diámetro Externo		Espesor de pared		Avance		Long de Rosca (min)		Peso nominal	
			(H)		(G)		(A)		(L2)		Aprox	
(NPS)	DN	Class	mm	inch	mm	inch	mm	inch	mm	inch	Lb	Kg
1/4"	8	3000	25.0	0.98	3.30	0.130	25.0	0.98	10.20	0.40	0.42	0.19
3/8"	10	3000	33.0	1.30	3.51	0.138	28.0	1.10	10.40	0.41	0.93	0.08
1/2"	15	3000	38.0	1.50	4.09	0.161	33.0	1.30	13.60	0.54	1.20	0.54
3/4"	20	3000	46.0	1.81	4.30	0.169	38.0	1.50	13.90	0.55	1.84	0.83
1"	25	3000	56.0	2.20	4.98	0.196	44.0	1.73	17.30	0.68	3.05	1.38
1-1/4"	32	3000	62.0	2.44	5.28	0.208	51.0	2.01	18.00	0.71	3.62	1.64
1-1/2"	40	3000	75.0	2.95	5.56	0.219	60.0	2.36	18.40	0.72	6.65	3.02
2"	50	3000	84.0	3.31	7.14	0.281	64.0	2.52	19.20	0.76	7.15	3.24
2-1/2"	65	3000	102.0	4.02	7.65	0.301	83.0	3.27	28.90	1.14	13.70	6.21
3"	80	3000	121.0	4.76	8.84	0.348	95.0	3.74	30.50	1.20	21.00	9.53