

TEE RECTA

WP-316/316L SCH 10

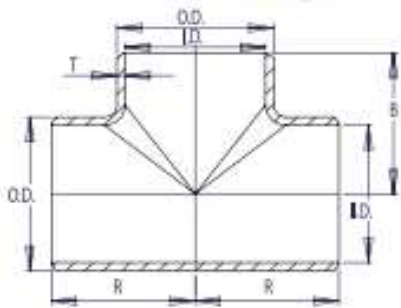

Conforme a:
 ASME B16.9 y ASTM A-403

Diámetro Nominal		Identificación	Diámetro Externo (OD)		Diámetro Interno (ID)		espesor de pared (T)		Centro a Centro (R)		Centro a Fin (B)		Peso nominal	
(NPS)	DN		mm	inch	mm	inch	mm	inch	mm	inch	mm	inch	Lb	Kg
1/2"	15	10	21.3	0.84	17.12	0.67	2.1	0.083	25.4	1.00	25.4	1.00	0.20	0.09
3/4"	20	10	26.7	1.05	22.5	0.88	2.1	0.083	28.4	1.12	28.4	1.12	0.29	0.13
1"	25	10	33.4	1.32	27.9	1.10	2.8	0.109	38.1	1.50	38.1	1.50	0.62	0.28
1-1/4"	32	10	42.2	1.66	36.6	1.44	2.8	0.109	47.8	1.88	47.8	1.88	1.08	0.49
1-1/2"	40	10	48.3	1.90	42.7	1.68	2.8	0.109	57.2	2.25	57.2	2.25	1.50	0.68
2"	50	10	60.3	2.38	54.8	2.16	2.8	0.109	63.5	2.50	63.5	2.50	1.87	0.85
2-1/2"	65	10	73.0	2.88	66.9	2.64	3.0	0.120	76.2	3.00	76.2	3.00	3.11	1.41
3"	80	10	88.9	3.5	82.8	3.3	3.0	0.120	85.9	3.4	85.9	3.4	3.90	1.77
4"	100	10	114.3	4.5	108.2	4.3	3.0	0.120	104.6	4.1	104.6	4.1	7.63	3.46