

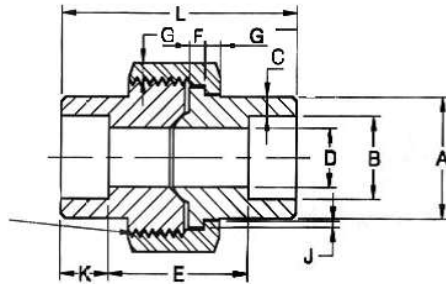

**CLASS 3000**
**UNION UNIVERSAL SOCKET-WELD**

H-Thrd's  
 Minimum 4 Full Thrd's  
 Engagement Class 2A/2B Fit  
 ANSI B1.1



**Conforme a:**  
 ASME B16.11 – MSS-SP-83  
 ASTM A-105

**UNION UNIVERSAL CLASS 3000 SOCKET WELDING**

Diámetro Nominal		Rating pressure	Diámetro Externo Socket		Diámetro Interno Socket		Espesor pared Socket		Diámetro Interno Fitting		Longitud tramo diametro interno		Espesor tuerca (min)		Hilos de Rosca por cada 25.4 mm	altura de Socket (min)		Longitud		Peso nominal	
(NPS)	DN	Class	(A) [Nota 1]		(B) [Nota 1]		(C)		(D) [Nota 1]		(E) [Nota 1]		(G)		(H)	(K)		(L)		Aprox	
			mm	inch	mm	inch	c	inch	mm	inch	mm	inch	mm	inch	min	mm	inch	mm	inch	Kg	Lb
1/2"	15	3000	31.20	1.23	22.23	0.88	4.09	0.16	16.60	0.65	26.9	1.06	3.68	0.14	14	9.7	0.38	49.0	1.93	0.35	0.77
					21.73	0.86			15.04	0.59	20.6	0.81									
3/4"	20	3000	37.10	1.46	27.56	1.09	4.27	0.17	21.69	0.9	31.8	1.3	4.06	0.16	11	12.7	0.50	56.9	2.24	0.49	1.08
					27.05	1.06			20.17	0.8	25.4	1.0									
1"	25	3000	45.50	1.79	34.29	1.35	4.98	0.20	27.41	1.08	34.3	1.35	4.45	0.18	11	12.7	0.50	62.0	2.44	0.81	1.79
					33.78	1.33			25.88	1.02	26.2	1.03									



UNION UNIVERSAL CLASS 3000 SOCKET WELDING																					
Diámetro Nominal		Rating pressure	Diámetro Externo Socket		Diámetro Interno Socket		Espesor pared Socket		Diámetro Interno Fitting		Longitud tramo diámetro interno		Espesor tuerca (min)		Hilos de Rosca por cada 25.4 mm	altura de Socket (min)		Longitud		Peso nominal	
			(A) [Nota 1]		(B) [Nota 1]		(C)		(D) [Nota 1]		(E) [Nota 1]		(G)		(H)	(K)		(L)		Aprox	
(NPS)	DN	Class	mm	inch	mm	inch	c	inch	mm	inch	mm	inch	mm	inch	min	mm	inch	mm	inch	Kg	Lb
1-1/4"	32	3000	54.90	2.16	43.05	1.69	5.28	0.21	35.81	1.4	40.6	1.6	5.21	0.21	11	12.7	0.50	71.1	2.80	1.10	2.43
					42.55	1.68			34.29	1.4	32.5	1.3									
1-1/2"	40	3000	61.50	2.42	49.15	1.94	5.54	0.22	41.66	1.64	42.2	1.66	5.59	0.22	10	12.7	0.50	76.5	3.01	1.61	3.55
					48.64	1.91			40.13	1.58	34.0	1.34									
2"	50	3000	75.20	2.96	61.62	2.43	6.05	0.24	53.26	2.1	45.5	1.8	6.35	0.25	10	15.7	0.62	86.1	3.39	2.16	4.76
					61.11	2.41			51.74	2.0	37.3	1.5									
2-1/2"	65	3000	91.70	3.61	74.45	2.93	7.67	0.30	64.24	2.53	61.7	2.43	7.11	0.28	8	15.7	0.62	102.4	4.03	3.50	7.72
					73.81	2.91			61.19	2.41	52.1	2.05									
3"	80	3000	109.20	4.30	90.42	3.56	8.31	0.33	79.45	3.1	63.8	2.5	8.00	0.31	8	15.7	0.62	109.0	4.29	5.15	11.35
					89.79	3.54			76.40	3.0	53.6	2.1									

H-Thrd's  
 Minimum 4 Full Thrd's  
 Engagement Class 2A/2B Fit  
 ANSI B1.1

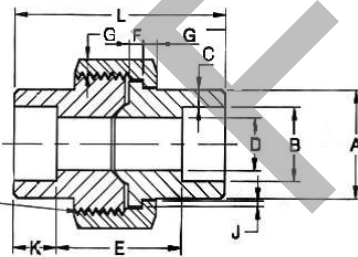

**Conforme a:**  
 ASME B16.11 – MSS-SP-83  
 ASTM A-105

**Nota:**  
 Valores mínimos y máximos de las dimensiones indicadas